

REASSEMBLY

1. INSTALL SLIDE MOTOR

Connect the seat adjuster drive cable, then install slide motor with the 2 screws.

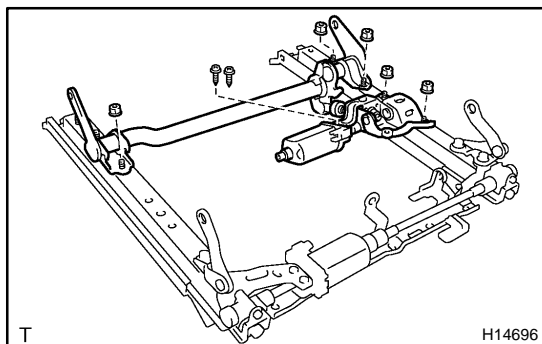

2. INSTALL VERTICAL SEAT LINK SUB-ASSEMBLY AND REAR VERTICAL MOTOR

- (a) Install the rear vertical motor with the 2 screws.
- (b) Install the plate and vertical seat link sub-assembly with the 5 nuts.

Torque: 26 N·m (270 kgf-cm, 20 ft-lbf)

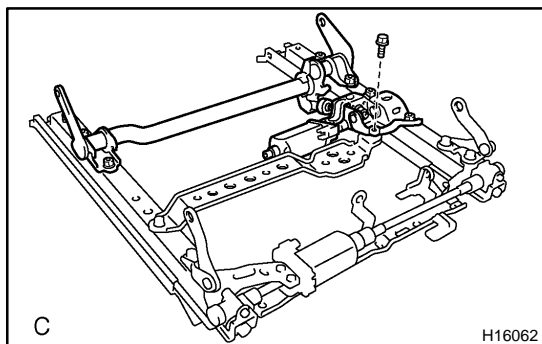

- (c) w/ Power seat control:
Install the bolt.

Torque: 7.8 N·m (80 kgf-cm, 69 in.-lbf)

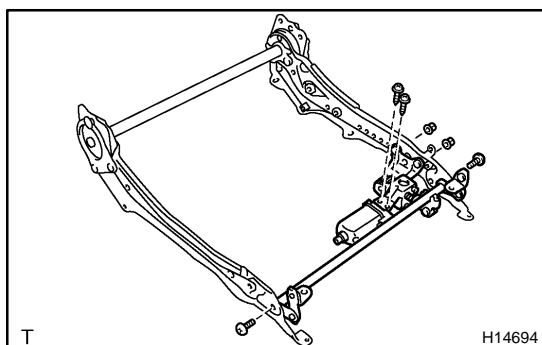

3. INSTALL NO. 2 VERTICAL SEAT LINK SUB-ASSEMBLY AND FRONT VERTICAL MOTOR

- (a) Install the front vertical motor with the 2 screws.
- (b) Install the No. 2 vertical seat link sub-assembly with the 2 nuts.

Torque: 20 N·m (200 kgf-cm, 14 ft-lbf)

- (c) Using a torx socket wrench, install the 2 bolts.

Torque: 29 N·m (300 kgf-cm, 22 ft-lbf)

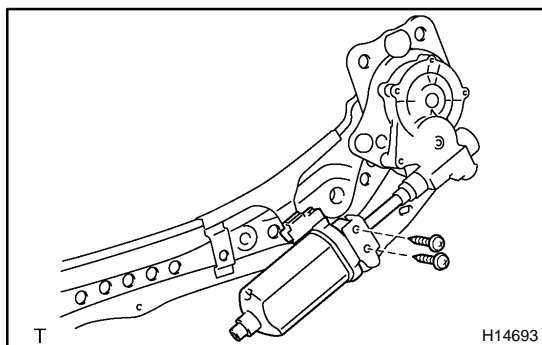

4. INSTALL RECLINING SEAT ADJUSTER ASSEMBLY WITH NO. 2 VERTICAL SEAT LINK SUB ASSEMBLY

- (a) Connect the shaft.
- (b) Install the reclining motor with the 2 screws.

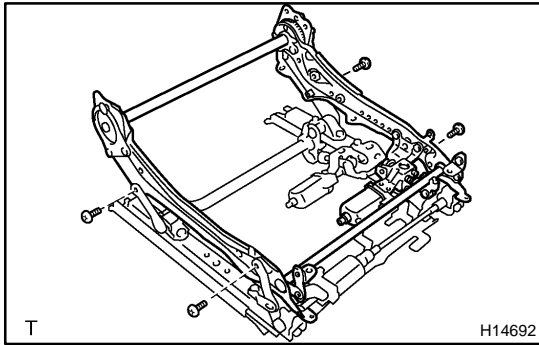

- (c) Using a torx socket wrench, install the reclining seat adjuster assembly with No. 2 vertical seat link sub-assembly with the 4 bolts.

Torque: 20 N·m (200 kgf-cm, 14 ft-lbf)

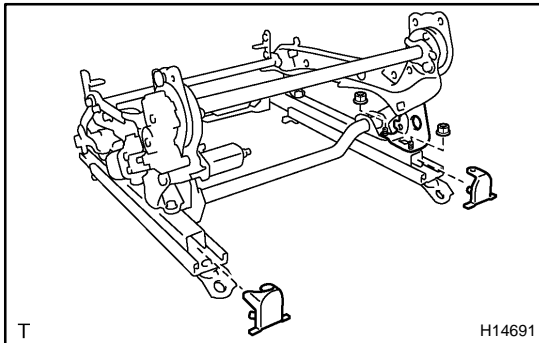

5. INSTALL SEAT TRACK COVERS AND BELT ANCHOR BRACKET

- (a) Install the belt anchor bracket with the 2 nuts.

Torque: 26 N·m (270 kgf-cm, 20 ft-lbf)

- (b) Install the 2 seat track covers.

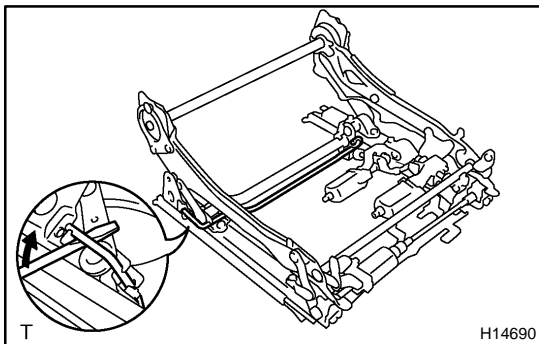

6. INSTALL TORSION BAR

Using a screwdriver, install the torsion bar.

7. w/ Power seat control:

INSTALL SEAT POSITION CONTROL RELAY

Install the seat position control relay with the 2 nuts.

8. INSTALL WIRE HARNESS

Connect the connectors, then install the wire harness to the seat adjuster.

9. INSTALL POWER SEAT SWITCH

Install the power seat switch with the 2 screws.

10. INSTALL SEATBACK COVER

- Install the seatback cover with new hog rings to the seatback pad.
- Install the lumbar support assembly with the 2 bolts to the seatback frame.
- Install the seatback cover with pad to the seatback frame with the 2 bolts and new hog rings.

HINT:

When installing hog rings, take care to prevent wrinkles as least as possible.

- Install the headrest supports.

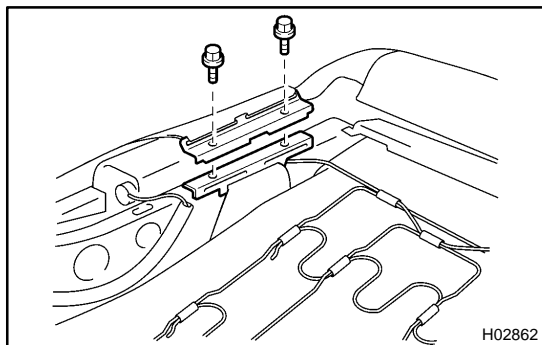

- (e) Install the seat cover hook and retainer to the seatback frame with the 2 bolts.
- (f) Install new hog rings.

HINT:

When installing hog rings, take care to prevent wrinkles as least as possible.

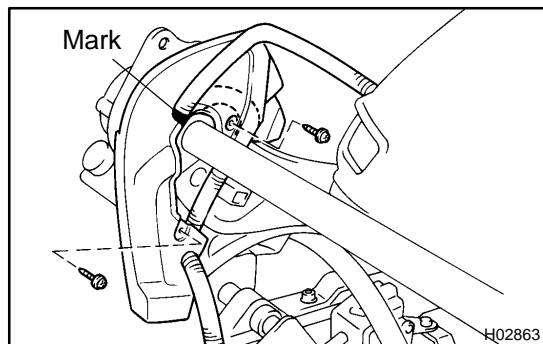
**11. INSTALL SEATBACK ASSEMBLY**

- (a) Install the covers to the outer and inner seat tracks.
- (b) Install the wire harness to the seat cushion inside covers as shown in the illustration.

NOTICE:

Be careful not to damage the wire harness.

- (c) Install the seat cushion inside covers with the 4 screws.
- (d) Install the seatback assembly with the 4 bolts.

Torque: 61 N·m (622 kgf·cm, 45 ft·lbf)

- (e) Install new hog rings.

HINT:

When installing hog rings, take care to prevent wrinkles as least as possible.

- (f) Install the seatback board with the 2 screws to the seatback assembly.

12. INSTALL SEAT CUSHION COVER

- (a) Install the seat cushion cover with new hog rings to the seat cushion pad.
- (b) Install the seat cushion cover with pad to the seat cushion frame with new hog rings.

HINT:

When installing hog rings, take care to prevent wrinkles as least as possible.

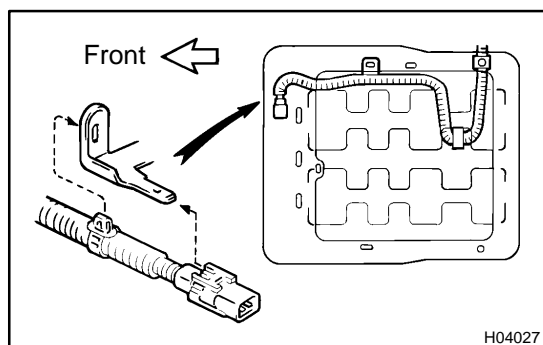
**13. INSTALL SEAT CUSHION ASSEMBLY**

- (a) Install the seat cushion assembly with the 4 bolts to the seat adjuster.
- (b) Install the wire harness to the seat cushion, as shown in the illustration.

Torque: 19 N·m (194 kgf·cm, 14 ft·lbf)

14. INSTALL FRONT SEAT INNER CUSHION COVER**15. INSTALL FRONT SEAT CUSHION SHIELD****16. INSTALL NO. 1 FRONT SEAT CUSHION SHIELD**

17. INSTALL FRONT SEAT INNER BELT

Install the bolt and front seat inner belt.

Torque: 42 N·m (430 kgf·cm, 31 ft·lbf)

18. INSTALL POWER SEAT SWITCH KNOBS**19. INSTALL HEADREST**